

Dimensions of opening

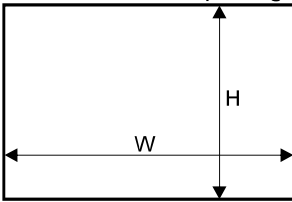

handle length = door height

ATTENTION! Calculations for handle with inserted brush

door height	- h	$h = H - 38 \text{ mm}$
board height	- hb	$hb = h - 2 \text{ mm}$
door width	- w	$w = (W - 3 + Z) : N$
board width #18	- wb	$wb = w - 22 \text{ mm}$
board width #12	- wb _m	$wb_m = w - 7 \text{ mm}$
angle section length	- la	this size is determined after door construction

number of doors	- N	2	3
total overlap	- Z	36 mm	72 mm

visual design - 4 wings

	$w = (W + 105) : 4$
	$w = (W : 2 + 33) : 2$

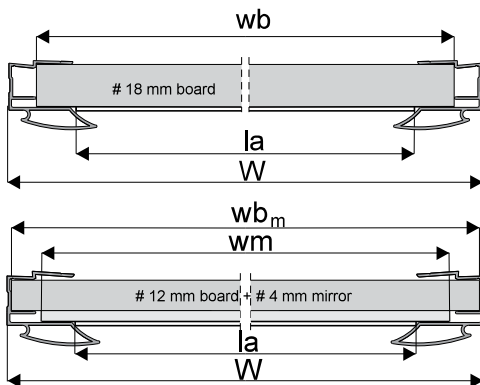

mirror dimension

mirror height - hm = hb - 4 mm

mirror width - wm = wb_m - 20 mm

ATTENTION:
Board to mirror contact area should be free from dirt and grease before applying double-sided tape.

Broken line indicates recommended positioning of double-sided tape

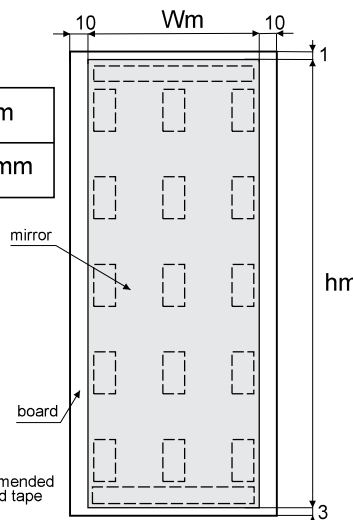

- When fitting handle profiles, do not use assembly adhesive
- The handle should be fixed to board with fastening screws on the inner door face

Installation method for handle and guiding carriage with # 18 mm board

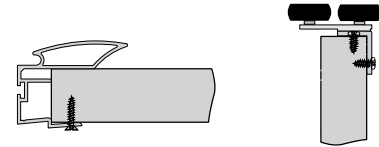

Installation method for handle and guiding carriage with # 12 mm board + # 4 mm mirror

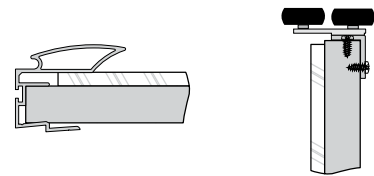

Installation method for angle section 1 1 mm x 17 mm

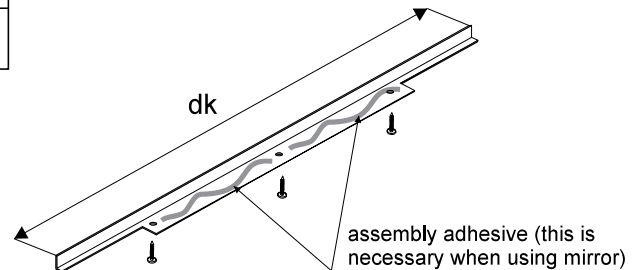
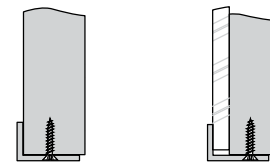

ATTENTION !

Angle section must be fastened to board with minimum 3 screws $\varnothing 3 \times 25$.

ATTENTION !

Handle profile should be 2mm longer than board height.

WARNING

SEVROLL does not bear any responsibility for deformation resulting from the application of improper quality of boards (improper storage, improper humidity)



LINE UNIVERSAL GM

Installation method for line **UNIVERSAL GM**
in system GEMINI 18

SYSTEM GEMINI 18 EVEREST

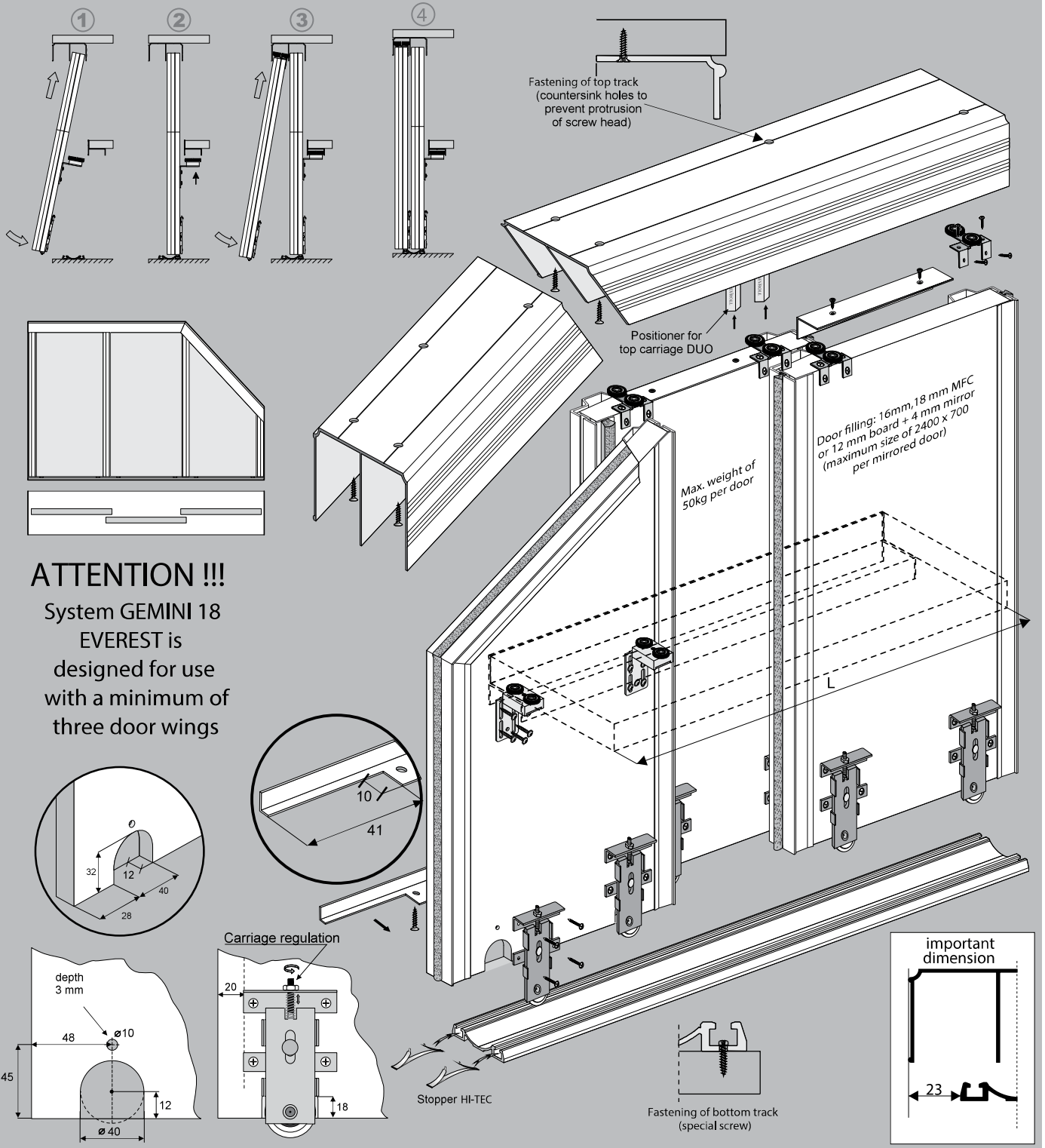

ATTENTION !!!
System GEMINI 18
EVEREST is
designed for use
with a minimum of
three door wings

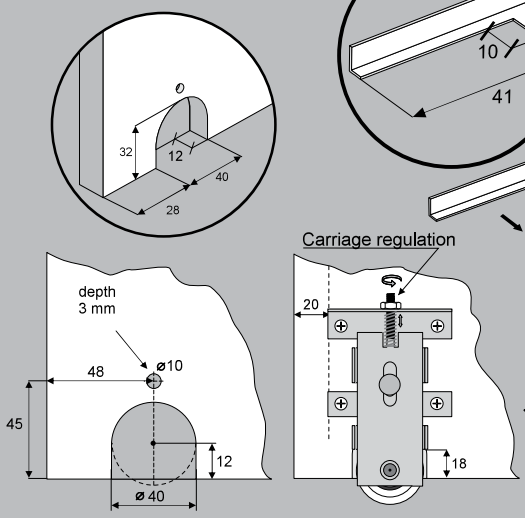

COMPONENTS

<p>Handle Universal GM</p> <p>anti-dust brushes (with glue) 6,7 mm x 9 mm</p> <p>textile door stop (inserted) 4,8 mm x 4 mm</p> <p>#16 i #18</p> <p>Length 2,7 m</p>	<p>Top track Gemini-Decor</p> <p>76 mm</p> <p>Length 1,7 m, 2,35 m, 3,0 m, 4,05 m, 6,0 m</p>	<p>Track Everest</p> <p>Length 3,0 m</p>	<p>Bottom track Elegant</p> <p>Length 1,7 m, 2,35 m, 3,0 m, 4,05 m, 6,0 m</p>	<p>Angle section ZW</p> <p>20 mm x 18 mm</p> <p>Length 1,7 m, 2,35 m, 3,0 m</p>
<p>Guiding track Focus WPFc-Duo</p>	<p>Bottom track WD18V HI-TEC</p>	<p>Guiding track Everest WPEv-Duo</p>		